

SS664HF

SAFARI V-SPEC SNORKEL
MITSUBISHI MV TRITON MY24 (Dec 2023 onwards)
2.4L Bi-Turbo Diesel (4N16 Engine)



Initial Release 16/04/2025

Parts List

ITEM	PART NO.	DESCRIPTION	QTY
1	532-133-000	BODY - SNORKEL (SS664HF)	1
2	000-135-800	3 ½" AIR RAM ASSEMBLY	1
3	532-032-000	BRACKET - UPPER MOUNTING	1
4	000-002-100	BOLT - HEX - 6mm x 1.0 x 14mm (SEMS)	2
5	000-951-300	SCREW - S/T - 4.2mm x 16mm - S/S	3
6	000-960	INSERT - PLASTIC	3
7	000-110	STUD - 8mm x 1.25 x 25mm - S/S	6
8	000-311-300	WASHER - BODY - 8mm x 30mm - S/S	6
9	000-205-300	NUT - NYLOC - 8mm x 1.25mm - S/S	6
10	532-024-000	HOSE - AIR ENTRY	1
11	000-909	CLAMP - HOSE - 80/100mm	2
12	000-914/B	CLAMP - HOSE - SIZE 56 (BLACK)	1
13	532-016-000	INFILL PIECE - GUARD PANEL	1
14	532-017-000	TEMPLATE - GUARD PANEL	1

Installation Guide

Fitment to:

- Right Hand Side

Fitting Time:

- 150min

Special Tools:

- Body Saw (Reciprocating)
- Step Drill
- Files
- Sikaflex 227 Adhesive Sealant
- Loctite 243 (thread lock)
- Masking Tape
- Touch-up paint
- 8mm, 10mm Drill Bits
- Pilot Drill Bit

Prior to commencing the installation, it is the installer's responsibility to verify that all components and particularly the template (Item 14) are correct.

1

Remove the following in accordance with the factory service manual:

- Air Cleaner Assembly
- RHS Mud Flap
- RHS Guard Liner

2

Remove and discard

- Air intake Duct

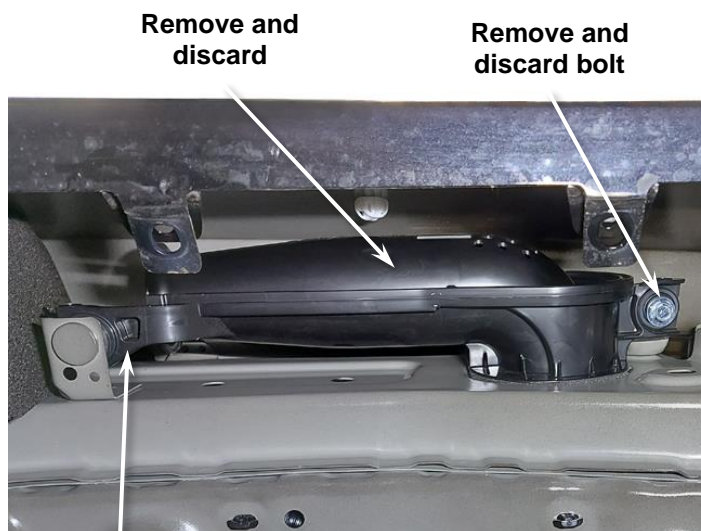

**Lift Inlet to
Remove**

3

- Remove and Retain
- Air Deflector



4

Non-Flare Models Only:

Do not remove perforated section from the guard panel template (Item 14).

Note: For models with factory flares fitted see step 5.



5

Factory Flare Fitted Models (GSR)

Using a sharp knife, remove and discard the lower perforated section from the guard panel template (Item 14) as shown.



Remove Perforated Section & Discard

Align the guard panel template (Item 14) to the upper and rear edges of the RHS guard panel as shown.

Tape the template to the guard panel with masking tape, ensure the template conforms to the guard panel.

Mark all hole positions and guard cut-out section with a felt tip pen.

Remove the template.

Note: For Factory Flare Fitted Vehicles (GSR Model) see step 7.

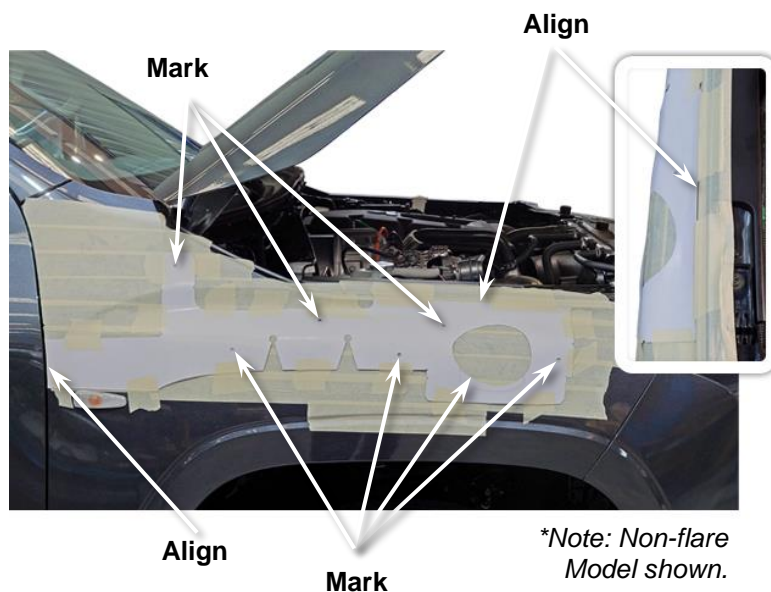

Align the guard panel template (Item 14) to the upper and rear edges of the RHS guard panel as shown.

Tape the template to the guard panel with masking tape, ensure the template conforms to the guard panel and factory fitted flare (GSR Models).

Mark all hole positions, guard cut-out section and the flare with a felt tip pen.

Remove the template.

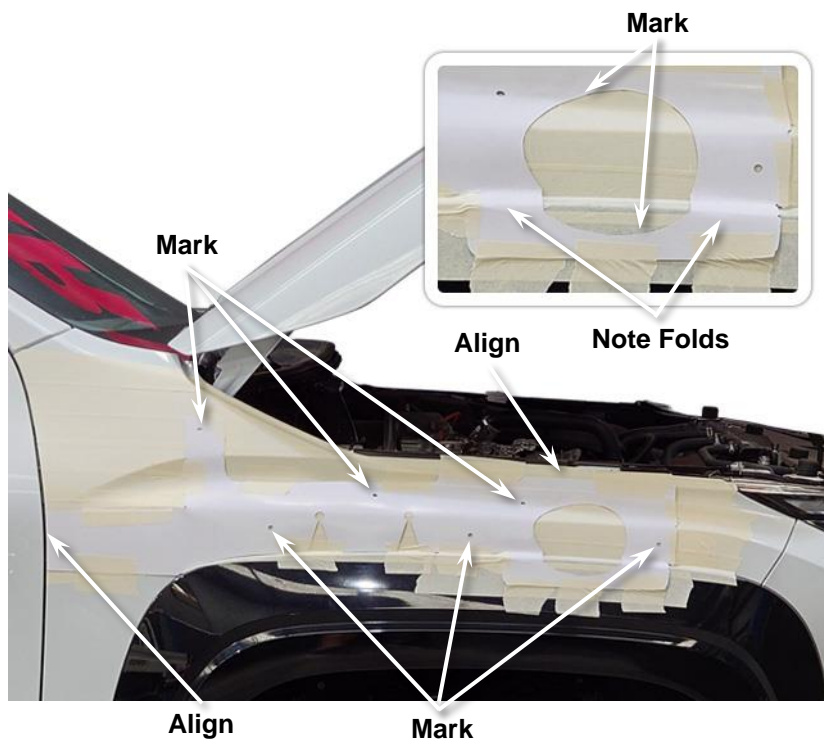

Drill a pilot hole for each of the marked hole positions.

Drill 2 or 3, 10mm diameter holes in the cut-out section for a start/stop point for the body saw.

Using a body saw, cut the main hole in the guard panel for the snorkel body outlet as marked in step 6 (cutting on the outside of the marked line).

Use a step drill to drill the six mounting holes to 16mm diameter.

Deburr and paint all holes.

N.B: For models fitted with factory flares it is recommended to:

- remove the flare
- cut & discard marked section
- mark the guard panel
- cut the guard panel
- re-install the flare.

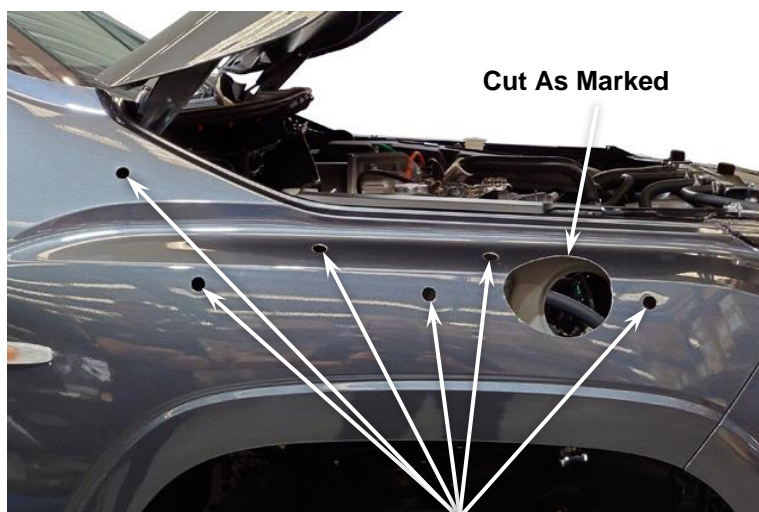

Step Drill 16mm Dia.

NEW ZEALAND INSTALLATIONS ONLY:

Safari have developed 2 methods of Snorkel A pillar attachment, for the conventional method please proceed with the current document alternatively please see the link below for further instructions.

www.safari4x4.co.nz/apillarmounting

Install the upper mounting bracket (Item 3) to the snorkel body (Item 1) with hex bolts (Item 4).

Apply Loctite 243 to each of the stainless-steel mounting studs (Item 7) and install the studs finger tight into the snorkel body (Item 1) mounting inserts as shown.

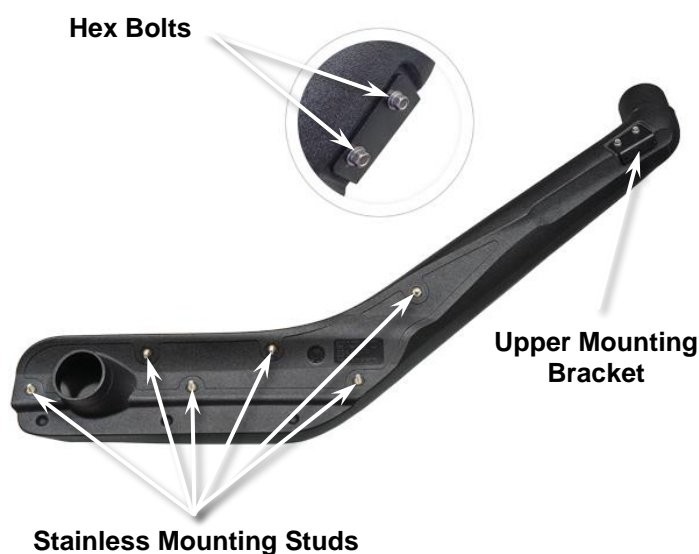

Non-Flare Models Only:

Apply Sikaflex adhesive sealant to the fender infill piece as shown.

Install the fender infill piece (Item 13) to the snorkel body (Item 1), tape the infill rubber to the snorkel body in several positions to hold the infill in position while the adhesive sealant cures.



Place a strip of masking tape along the A-pillar panel.

Carefully install the snorkel body (Item 1) to the guard panel.

With the snorkel body correctly positioned on the vehicle, accurately mark the position of the upper mounting bracket (Item 3) onto the masking tape.



12

Remove the snorkel body (Item 1) from the vehicle and remove the upper mounting bracket (Item 3) from the snorkel body.

Position the upper mounting bracket (Item 3) onto the A-pillar and align the bracket with the marked bracket outline.

Mark the three mounting hole positions with a felt tip pen.

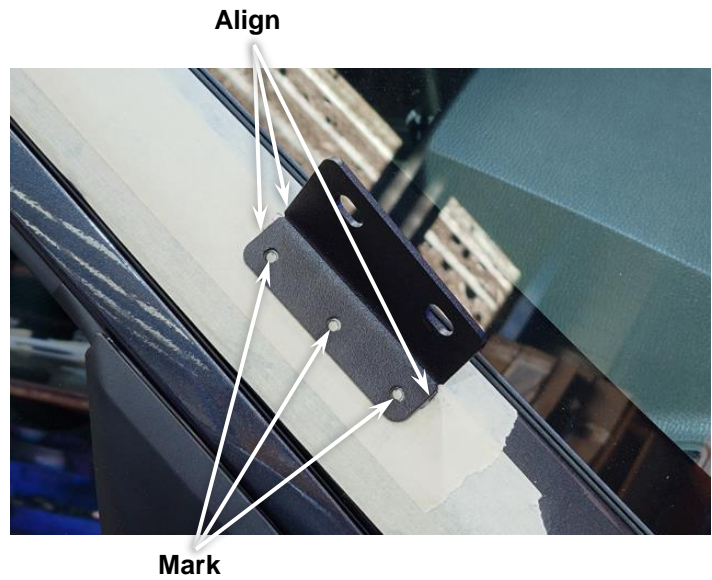

13

Drill a pilot hole at each of the three marked positions.

Drill the three A-pillar panel holes to 8mm diameter with a step drill or 8mm drill bit.

Deburr and paint holes.

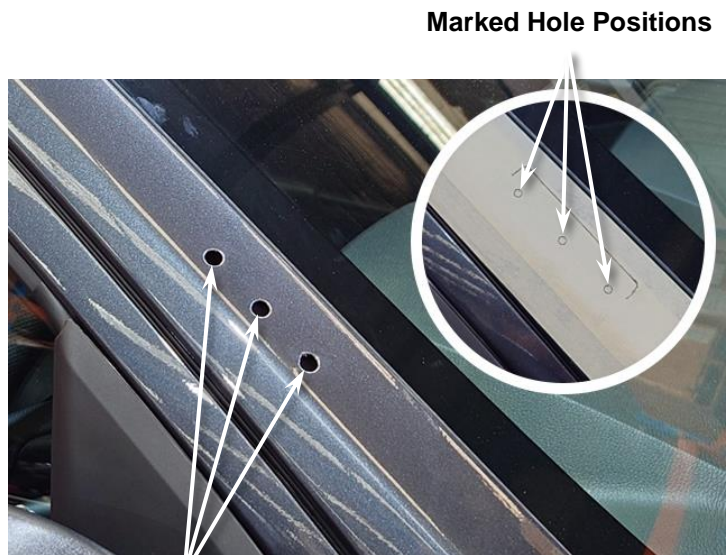

Drill A-pillar Panel to 8mm Dia.

14

Install the plastic inserts (Item 6) into the 8mm diameter holes in the A-pillar.

Secure the upper mounting bracket (Item 3) to the A-pillar with three self-tapping screws (Item 5).



15

Measure 45mm from the inlet end face of the air cleaner base and mark a cut line around the snout.

Cut along the marked line using a body saw and remove and discard the cut section.

Clean and file the end of the modified air cleaner base inlet.



16

INSTALLER OPTION:

The air cleaner base contains a drain valve as shown. The drain valve can permit water to enter the air intake.

Safari advises that the drain valve should be sealed to ensure a watertight installation.



17

From inside the engine bay, squash and install the air entry hose (Item 10) through the hole in the inner guard panel.

Loosely install both 80/100mm hose clamps (Item 11) onto either end of the air entry hose, as shown.

Note Orientation of Hose Clamps.

Air Entry Hose

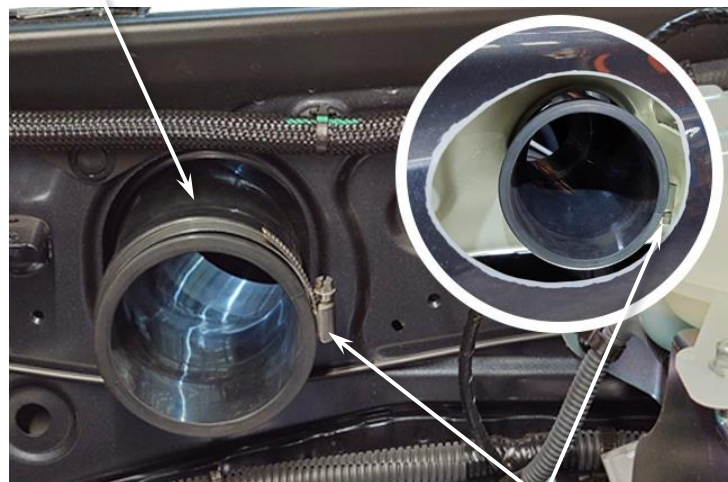

18

Re-install the air cleaner base into the vehicle guiding the modified air cleaner inlet into the air entry hose (Item 10).

Fasten the air cleaner base using standard mounting bolts.

Hose Clamp

Air Cleaner Base



19

Carefully install the snorkel body (Item 1) to the guard panel, carefully guiding the snorkel outlet snout into the air entry hose inlet, aligning the snorkel body to the guard panel and upper mounting bracket (Item 3).

Once correctly aligned, fasten the snorkel body to the guard panel with body washers (Item 8) and nyloc nuts (Item 9).

Fasten the snorkel body to the upper mounting bracket with hex bolts (Item 4).

Body Washers & Nyloc Nuts

Hex Bolts



Snorkel Body

20

Align the air entry hose (Item 10) for best fitment and correctly position the hose clamps at either end of the air entry hose and tighten.

Note: Ensure the air entry hose is installed hard up against the shoulder of the snorkel body outlet.

Hose Clamps 80/100

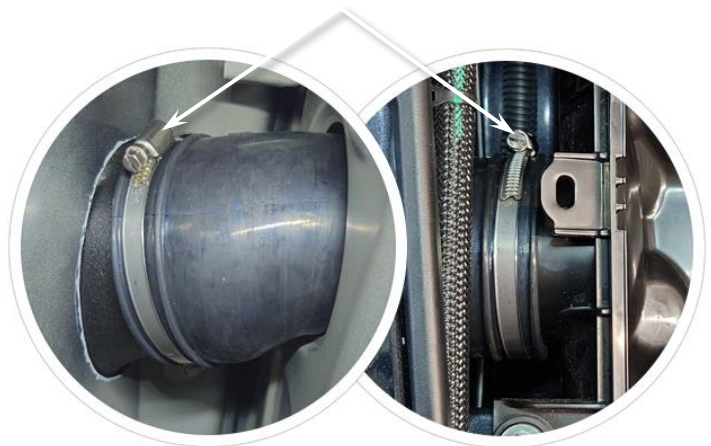

21

Install the black hose clamp (Item 12) loosely over the base of the air ram assembly (Item 2).

Install the air ram assembly onto the snorkel body.

Align the air ram assembly and tighten the black hose clamp (Item 12).



Black Hose Clamp

22

Install the guard liner, mud flap, air cleaner element, air cleaner lid, air deflector & reconnect sensor wiring along with any other items that may have been removed during the snorkel installation process.

23

N.B: It is the installer's responsibility to ensure that all connections are watertight.